



NC TOOLING SYSTEM

Our company is much delighted at presents the best products and to receive the coning of the High-Speed Age with our customers.

For the customers who use high-precision machine centers, always require high standard products. They emphasized mostly in the quality, efficiency, cost and safety. Corresponding to these expectations and to satisfy customers' requirements, K&JEX make the best improvements toward this aspect. By provide extensive levels of quality guarantee to let customers feel satisfied.



Technology

Humanity

μ age

SLIM CHUCK

Mandrino a pinza DC Slim Chuck

Slim Chuck DC Spannzangeaufnahme

DC Slim Chuck Extension Adaptor



Mandrino a pinza progettato senza ghiera, parte da un diametro di Ø8.6mm.
In questo modo si raggiunge l'effetto migliore nel processo di estensione.

Spannzangenaufnahme ohne Ring entworfen, mindest Durchmesser 8,6 mm.

In dieser Weise, erreichtet Es das bestes Effekt in dem Verlängerung Prozess.

Slim collet chuck designed without nut can get the smallest outside diameter of Ø8.6mm.

This can achieve the best effect on extended processing depth.

La varietà di lunghezze dello Slim Chuck fornisce possibilità differenti, la lunghezza max. è 300mm.

Die Slim Chuck Längen Palette beliefert verschiedene Möglichkeiten, die maximale Länge ist 300 mm.

Varies lengths of slim chuck provides different choices, the longest chuck is up to 300mm.

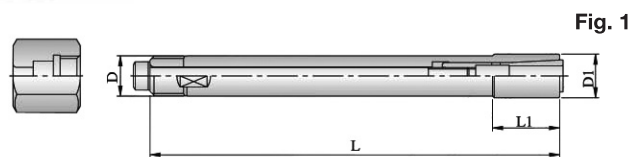

Fig. 1

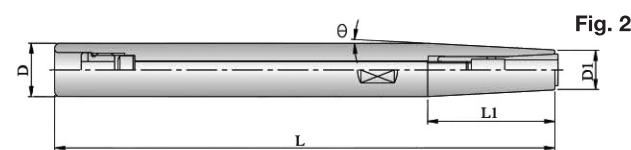

Fig. 2

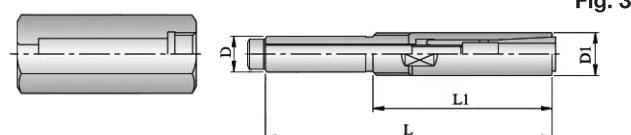

Fig. 3

Codice d'ordine Bestell-Nr. Order No.	Fig.	(mm) Dimensioni - Abmessungen - Dimensions						Pinza Spannzange Collet	Chiave Schlüssel Spanner	Vite Schraube Screw	Bussola Schraube Stop Screw	Estrattore Auszieher Stop Nut
		d	L	L1	D	D1	θ					
ST08-DC4-80	1	2~4	80	16,5	8	8,6	-	DC4	30194~632(M3)	M4L60	-	TP-M8
ST12-DC4-120	2	2~4	120	38	12	8,6	3°	DC4	30194~632(M3)	M4L85	OP-M8	-
ST10-DC6-80	3	2~6	80	50	10	13	-	DC6	30194~642(M4)	M5L55	-	TP-M12A
ST12-DC6-120	1	2~6	120	40	12	13	-	DC6	30194~642(M4)	M5L95	-	TP-M12
ST16-DC6-150	2	2~6	150	38	16	13	3°	DC6	30194~642(M4)	M5L100	OP-M10	-
ST20-DC6-200	2	2~6	200	70	20	13	3°	DC6	30194~642(M4)	M5L100	OP-M10	-
ST25-DC6-250	2	2~6	250	115	25	13	3°	DC6	30194~643(M4)	M5L100	OP-M10	-
ST20-DC8-150	2	3~8	150	28	20	19	2°	DC8	30194~652(M5)	M5L72	OP-M12	-
ST20-DC8-200	2	3~8	200	28	20	19	2°	DC8	30194~652(M5)	M6L120	OP-M12	-
ST25-DC10-150	2	3~10	150	28	25	24	2°	DC10	30194~662(M6)	M8L80	OP-M16	-
ST25-DC10-200	2	3~10	200	28	25	24	2°	DC10	30194~662(M6)	M8L100	OP-M16	-
ST25-DC10-250	2	3~10	250	28	25	24	2°	DC10	30194~662(M6)	M8L150	OP-M16	-
ST32-DC12-200	2	3~12	200	57	32	30	2°	DC12	30194~682(M8)	M10L120	OP-M18	-
ST32-DC12-250	2	3~12	250	57	32	30	2°	DC12	30194~682(M8)	M10L150	OP-M18	-
ST32-DC12-300	2	3~12	300	57	32	30	2°	DC12	30194~682(M8)	M10L150	OP-M18	-

Chiave (A)
Schlüssel (A)
Spanner (A)

Chiave (B)
Schlüssel (B)
Spanner (B)

Vite
Schraube
Screw

Bussola
Schraube
Stop Screw

Estrattore
Auszieher
Stop Nut

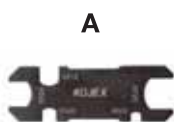

A

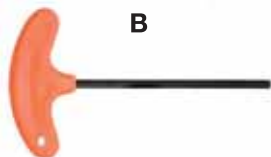

B



Codice d'ordine Bestell-Nr. Order No.
30194-002

Codice d'ordine Bestell-Nr. Order No.	mm	L
30194-632	3	100
30194-642	4	100
643	4	150
652	5	100
662	6	100
682	8	100

Codice d'ordine Bestell-Nr. Order No.	Filetto Gewinde Thread	L
M4L60	M4	60
M4L85	M4	85
M5L55	M5	55
M5L95	M5	95
M5L100	M5	100
M6L70	M6	70
M6L120	M6	120
M8L80	M8	80
M8L100	M8	100
M8L150	M8	150
M10L120	M10	150
M10L150	M10	150

Codice d'ordine Bestell-Nr. Order No.	Filetto Gewinde Thread
OP-M8	M8(L)
OP-M10	M10(L)
OP-M12	M12(L)
OP-M16	M16(L)
OP-M18	M18(L)

Il filetto della bussola è sinistro
Die Gewinde der Schraube ist links
thread of stop screw is leftward

Codice d'ordine Bestell-Nr. Order No.	Filetto Gewinde Thread
TP-M8	M8(L)
TP-M12A	M12(L)
TP-M12	M12(L)

Il filetto della bussola è sinistro
Die Gewinde der Schraube ist links
thread of stop screw is leftward

Set DC Slim Chuck - mandrino + pinze

Set DC Slim Chuck - aufnahme + spannzange

Set of DC Slim Chuck Extension Adaptor + collets



Fig. 2
Two Holders



Fig. 3
One Holder

DC4

Codice d'ordine Bestell-Nr. Order No.	Fig.	Contenuto set - Inhalt des sets - Set contents			
		Mandrino Aufnahme Collet Chuck	Pinza Spannzange Collet	Chiave (A) Schlüssel (A) Spanner (A)	Chiave (B) Schlüssel (B) Spanner (B)
SST08-DC4-80	1	ST08-DC4-80	DC4-2E x 1 pc DC4-3E x 1 pc DC4-4E x 1 pc	30194-002	30194-632(M3)
SST12-DC4-120	1	ST12-DC4-120			
SST0812-DC4	2	ST08-DC4-80 ST12-DC4-120			

DC6

Codice d'ordine Bestell-Nr. Order No.	Fig.	Contenuto set - Inhalt des sets - Set contents			
		Mandrino Aufnahme Collet Chuck	Pinza Spannzange Collet	Chiave (A) Schlüssel (A) Spanner (A)	Chiave (B) Schlüssel (B) Spanner (B)
SST12-DC6-120	1	ST12-DC6-120	DC6-3E x 1 pc DC6-4E x 1 pc DC6-6E x 1 pc	30194-002	30194-642(M4)
SST16-DC6-150	1	ST16-DC6-150			30194-642(M4)
SST20-DC6-200	1	ST20-DC6-200			30194-642(M4)
SST25-DC6-250	1	ST25-DC6-250			30194-642(M4)
SST1216-DC6	2	ST12-DC6-120 ST16-DC6-150			30194-642(M4)
SST2025-DC6	2	ST20-DC6-200 ST25-DC6-250			30194-642(M4) 30194-642(M4)

DC8

Codice d'ordine Bestell-Nr. Order No.	Fig.	Contenuto set - Inhalt des sets - Set contents			
		Mandrino Aufnahme Collet Chuck	Pinza Spannzange Collet	Chiave (A) Schlüssel (A) Spanner (A)	Chiave (B) Schlüssel (B) Spanner (B)
SST20-DC8-150	1	ST20-DC8-150	DC8-3E x 1 pc DC8-4E x 1 pc DC8-6E x 1 pc DC8-8E x 1 pc	30194-002	30194-652(M5)
SST20-DC8-200	1	ST20-DC8-200			

DC10

Codice d'ordine Bestell-Nr. Order No.	Fig.	Contenuto set - Inhalt des sets - Set contents			
		Mandrino Aufnahme Collet Chuck	Pinza Spannzange Collet	Chiave (A) Schlüssel (A) Spanner (A)	Chiave (B) Schlüssel (B) Spanner (B)
SST25-DC10-150	1	ST25-DC10-150	DC10-3E x 1 pc DC10-4E x 1 pc DC10-6E x 1 pc DC10-8E x 1 pc DC10-10E x 1 pc	30194-002	30194-662(M6)
SST25-DC10-200	1	ST25-DC10-200			
SST25-DC10-250	1	ST25-DC10-250			

DC12

Codice d'ordine Bestell-Nr. Order No.	Fig.	Contenuto set - Inhalt des sets - Set contents			
		Mandrino Aufnahme Collet Chuck	Pinza Spannzange Collet	Chiave (A) Schlüssel (A) Spanner (A)	Chiave (B) Schlüssel (B) Spanner (B)
SST32-DC12-200	1	ST32-DC12-200	DC12-3E x 1 pc DC12-4E x 1 pc DC12-6E x 1 pc DC12-8E x 1 pc DC12-10E x 1 pc DC12-12E x 1 pc	30194-927	30194-682(M8)
SST32-DC12-250	1	ST32-DC12-250			
SST32-DC12-300	1	ST32-DC12-300			

Mandrino UC Gold

UC Gold Aufnahme

UC Gold Chuck

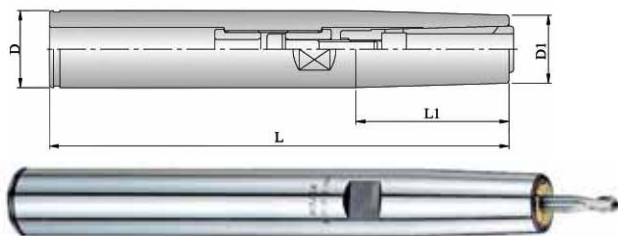

Progettati con pinza a tirante interno senza ghiera, possono ottenere grande rigidità ed alta stabilità.

Entworfen mit Innen-Behaltung Spannzangen ohne Ring, können einen starken Steifigkeit und große Stabilität erreichen.

Designed with inner-holding collet without nut can have strong stiffness rigidity and high stability.

Adatto per frese e alesatori aventi lo stesso diametro del gambo delle frese a candela.

Geeignet für VHM Fräser und VHM Reibahle mit selben Schaft-Durchmesser den VHM Fräser.

Suitable for end mills and reamer have the same shank diameter as end mills.

Codice d'ordine Bestell-Nr. Order No.	(mm) Dimensioni Abmessungen - Dimensions				Chiave Schlüssel Spanner	Vite Schraube Screw	Bussola Schraube Stop Screw
	L	L1	D	D1			
BC25-UC10-150	150	50	25	22	30194~653(M5)	M6L30	OP-M12A X 2
UC10-200	200	50	25	22	30194~653(M5)	M6L30	OP-M12A X 2

Pinza UC UC Spannzange UC Collet

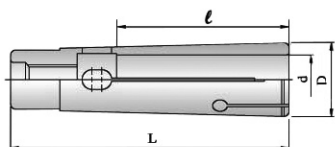

Quando si inserisce la fresa nella pinza, per ottenere la migliore performance si deve raggiungere la lunghezza "l".

Um der besten Performance zu erreichen, man muss die Fräser in der Spannzange bis zur Länge "l" einfügen.

When put end mill into collet must reach length "l" to get best performance.

Concentricità < 5µm
Rundlaufgenauigkeit < 5µm
Runout < 5µm

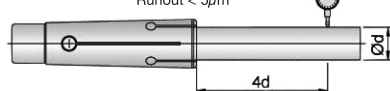

Codice d'ordine Bestell-Nr. Order No.	(mm) Dimensioni Abmessungen - Dimensions			
	d	l	D	L
UC10-3	3	15	15	56,5
4	4	20		
5	5	20		
6	6	25		
8	8	30		
10	10	35		



Chiave (A)
Schlüssel (A)
Spanner (A)

Chiave (B)
Schlüssel (B)
Spanner (B)

Vite
Schraube
Screw

Bussola
Schraube
Stop Screw

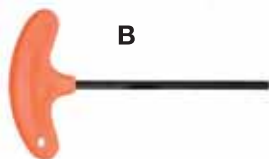
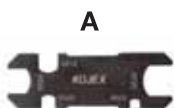

Codice d'ordine Bestell-Nr. Order No.
30194-002

Codice d'ordine Bestell-Nr. Order No.	mm	L
30194-653	5	150

Codice d'ordine Bestell-Nr. Order No.	Filetto Gewinde Thread	L
M6L30	M6	30

Codice d'ordine Bestell-Nr. Order No.	Tipo Typ Type
OP-M12A	Hexagon socket

Il filetto della bussola è sinistro
Die Gewinde der Schraube ist links
thread of stop screw is leftward